

# 10 JW “SPECIAL SWIVEL”

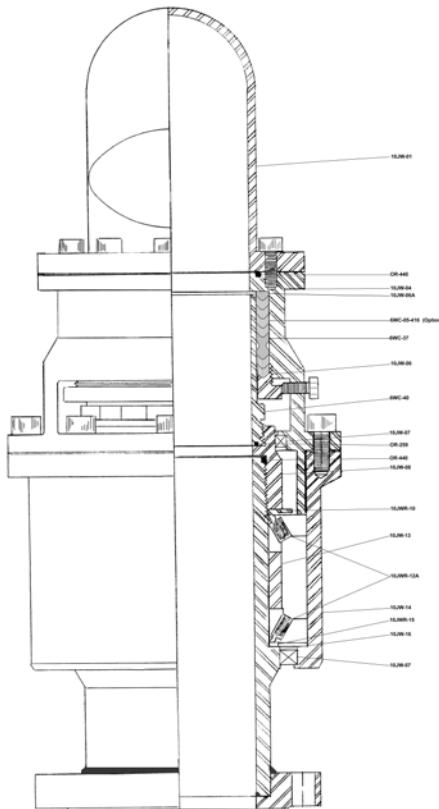

- Fluid Passage – 6”
- Adjustable tapered roller bearing
- Adjustable Chevron (V-Ring) Packing
- Grease Lubricated – Bearings & Packing
- Available for airlift reverse drilling

### TECHNICAL DATA

LENGTH	WIDTH	WEIGHT	HOSE CONN.	LOWER CONN.	FLUID PASSAGE	WORKING PRESSURE
28”	12 7/8		150 Flange	150 Flange	6	TO 1500 PSI

**WEIGHT CAPACITY**  
DESIGNED FOR PRESSURE LOAD ONLY

### PARTS LIST

PART NUMBER	DESCRIPTION	WT/LBS	QTY. REQ.	PRICE
<b>10JW-2090-XX</b>	WESTERN ROTATING HEAD, 6” ID, 6” 150# FLANGE HOSE CONNECTION, WITH 2” NPT FEMALE AIRLINE CONNECTION, 6” 150# FLANGE LOWER CONNECTION			12,647.00
10JW-01	GOOSENECK, 6” 150# FLANGE WITH 2” NPT AIRLINE CONNECTION		1	1712.04
10JW-04	BONNET		1	3527.14
10JW-06	PACKING ADJUSTING GLAND		1	806.34
10JW-06A	PACKING ADAPTER RING		1	161.78
10JW-07	HOUSING SEAL		2	116.26 ea
10JW-08	SPINDLE NUT		1	771.96
10JW-13	BEARING (CUP AND CONE)		2	CONSULT
10JW-14	BEARING HOUSING		1	2636.36
10JW-16	SPINDLE, 6” 150# FLANGE		1	2467.74
10JWR-10	BEARING SHIELD		1	237.83
10JWR-12A	INNER BEARING SPACER		1	290.98
10JWR-15	LOWER BEARING SPACER		1	166.82
6WC-05-416	PACKING SET, LOW PRESSURE		1	142.30
6WC-05	PACKING SET, HIGH PRESSURE		OPTION	142.30
6WC-37	LANTERN RING		1	168.02
6WC-40	WASHPIPE		1	467.87
OR-259	O RING (WASHPIPE)		1	4.00
OR-440	O RING (BONNET AND NUT)		2	4.00 ea

Other sizes of connections available, please consult factory.

Option for above swivel, may affect pricing of complete swivel. Other options available, please consult factory.

