

60DWS

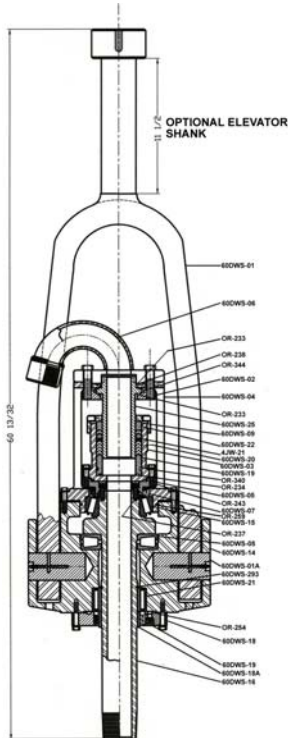

- Designed for well servicing and shallow oilfield drilling
- Grease lubricated Chevron packing
- Floating (self aligning) washpipe
- Oil lubricated bearings
- Three (3) bearing design:
Tapered roller-upthrust/alignment
Full apex roller – main
Needle roller – alignment

TECHNICAL

PACKING	LENGTH	WT/LB	HOSE CONN.	LOWER CONN.	WORKING PRESSURE	FLUID OPENING
Chevron	60 13/32	400	2 1/2" NPT	2 7/8 EUE LH	TO 3000 PSI	2"

WEIGHT CAPACITY

STATIC LOAD	ROTATING LOAD	DRILL DEPTH	SIZE/WT/LB
120,000	60,000 @ 100 RPM	6000 FT 4000 FT	2 3/8" / 6.65 2 7/8" / 10.4

PARTS LIST

PART NUMBER	NAME	QTY. REQ.	PRICE
60DWS-01	BAIL	OPTION	
60DWS-06	GOOSENECK	OPTION	
OR-259	O RING	2	C
OR-344	O RING	1	
60DWS-02	UPPER FLANGE	1	O
60DWS-04	BONNET	1	
OR-233	O RING	1	N
60DWS-25	WASHPIPE	1	
60DWS-09	GLAND, PACKING ADJ.	1	S
OR-340	O RING	2	
60DWS-19	GLAND, PACKING	1	U
4JW-21	RING, LANTERN	1	
60DWS-20	PACKING SET	1	L
60DWS-03	BOX, PACKING	1	
60DWS-22	RING, PACKING SEAT	1	T
OR-238	O RING	1	
60DWS-05	ADAPTER, SPINDLE	1	
OR-243	O RING	1	
60DWS-07	SEAL, UPPER	1	
OR-237	O RING	1	
60DWS-14	HOUSING, BEARING	1	
60DWS-01A	PIN, BAIL	2	
60DWS-293	RING, RETAINER	1	
60DWS-15	BEARING, UPPER	1	
60DWS-05	BEARING, MAIN	1	
60DWS-21	BEARING, LOWER	1	
OR-254	O RING	1	
60DWS-18	BOX, OIL	1	
60DWS-19	SEAL, LOWER	2	
60DWS-18A	SLEEVE, WEAR	1	
60DWS-16GU-LP	SPINDLE, 2 7/8" EUE LH PIN	1	
OR-233	O RING	1	

Other sizes of connections available, please consult factory.

Option for above swivel, may affect pricing of complete swivel. Other options available, please consult factory.

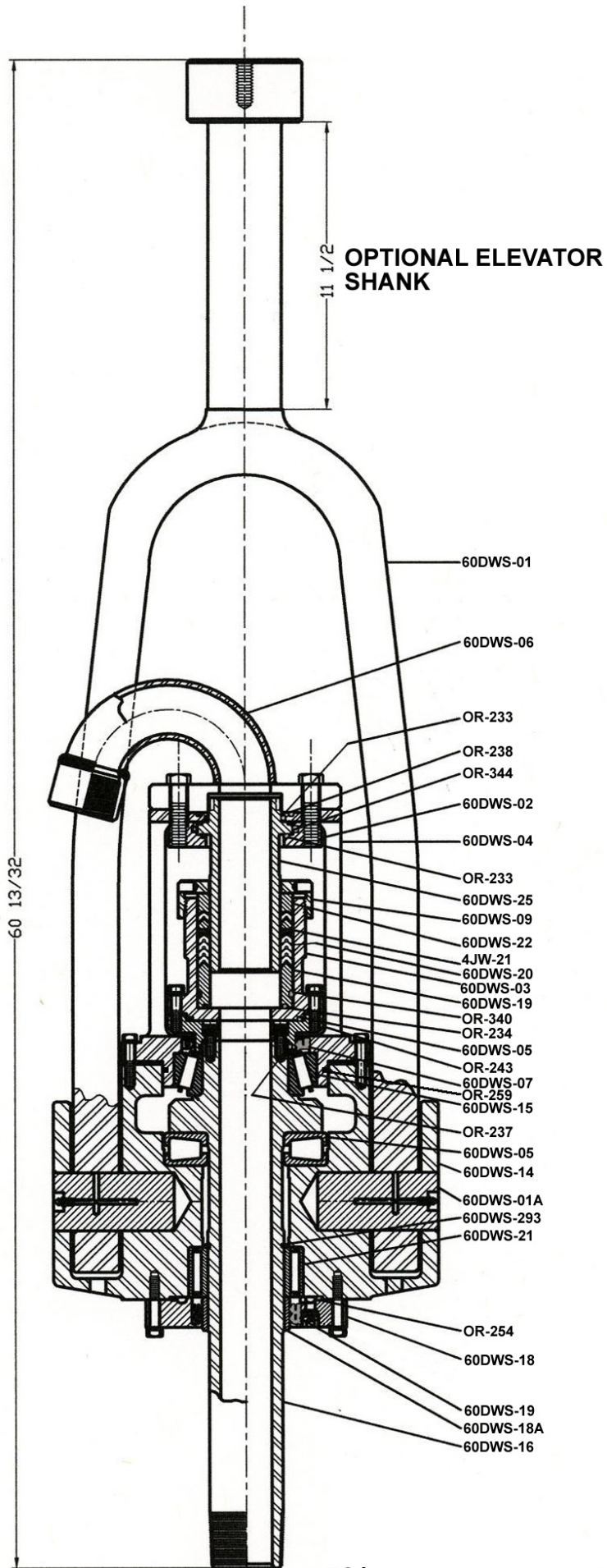

76A